

① Make a hole in the wall.

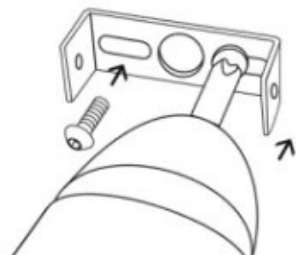

② Install the bottom frame.

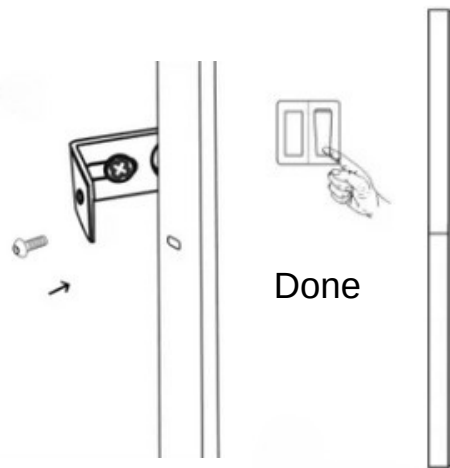

④ Fix the lamp to the base with the provided screws



③ Install the lamp on the bottom frame.

Splicing installation pay attention to the upper and lower positions of the opening through the wire, as shown in the figure.

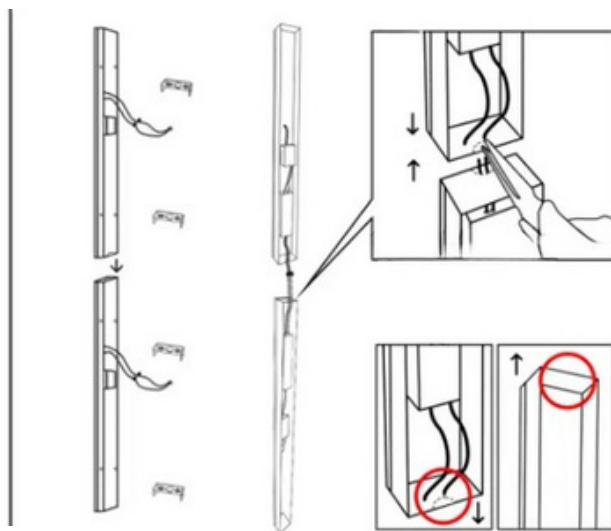

Pry open the predetermined interface position so that the wires can pass through

Single lamp installation
The dotted line of the reserved wiring must be installed in the downward direction to prevent water seepage.

Installation Precautions:

Note: Make sure the power is turned off.

1. Drill two holes on the wall, and knock in the two expansion tubes according to step 1 (Warning: make sure that the mounting location you drill is no gas, water or electricity pipes)
2. Fix the base to the wall with the provided screws (see step 2)
3. See step 3, connect the neutral wire and the live wire with the lamp (the earth wire is unnecessary)
4. Fix the lamp to the base with the provided screws
5. After checking for correctness, reconnect the power and complete the installation. If you have any questions, please contact our customer service or official email.