

1

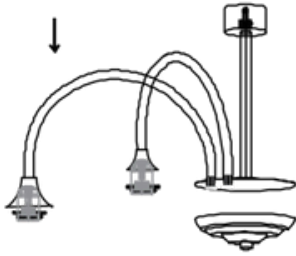

Mounting lamp body: the lamp arm is connected to the center post by screws

2

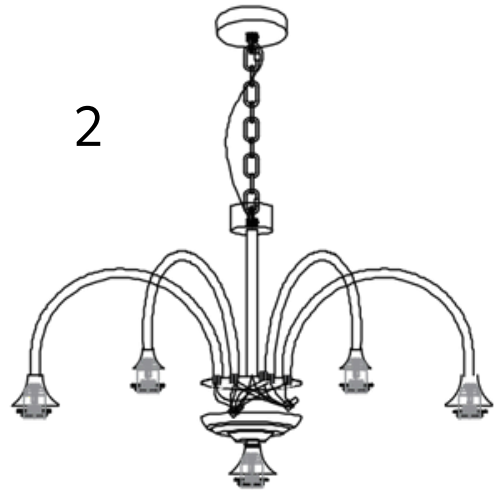

The lamp arm wire is connected to the main line

3

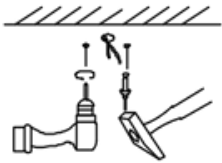

Drill holes in the ceiling and insert expansion screws

4

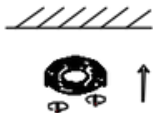

Install the hanging plate on the ceiling

5



The electric wires in the home connect to the light fixtures

6

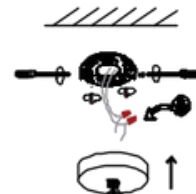

5x lampshade

5x bulb

Install bulbs and lampshades

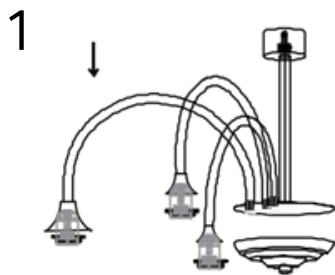

1
Mounting lamp body: the lamp arm is connected to the center post by screws

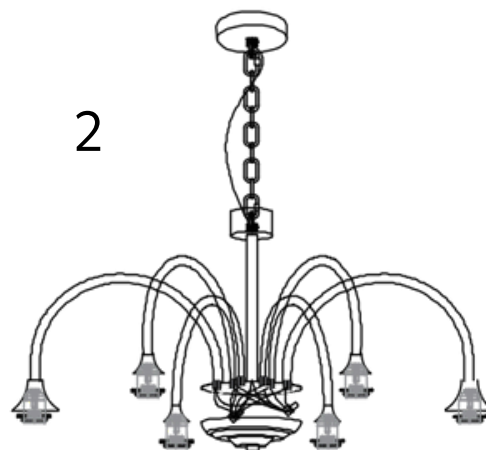

2
The lamp arm wire is connected to the main line

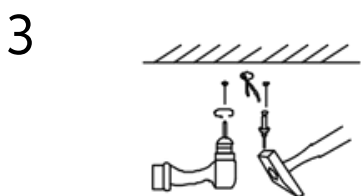

3
Drill holes in the ceiling and insert expansion screws

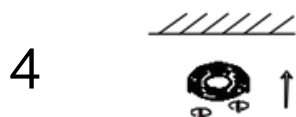

4
Install the hanging plate on the ceiling



5
The electric wires in the home connect to the light fixtures

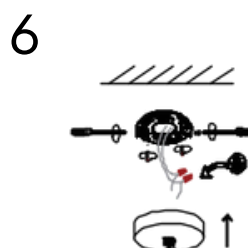

6x lampshade

6x bulb

Install bulbs and lampshades

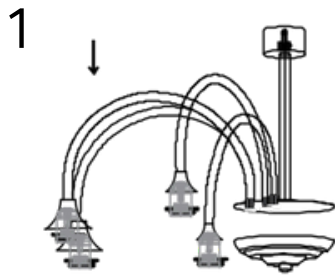

1
Mounting lamp body: the lamp arm is connected to the center post by screws

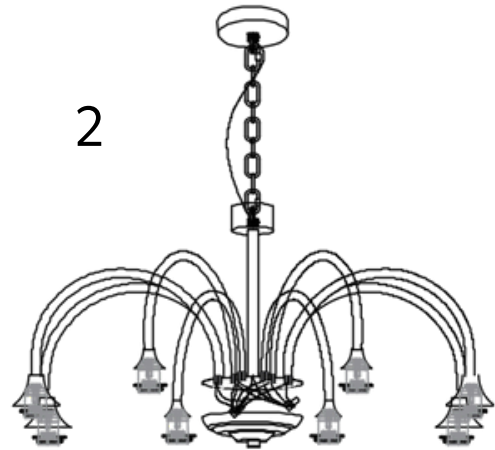

2
The lamp arm wire is connected to the main line

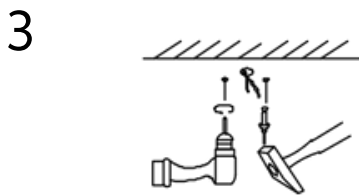

3
Drill holes in the ceiling and insert expansion screws

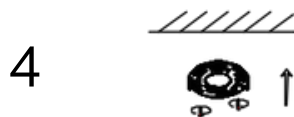

4
Install the hanging plate on the ceiling

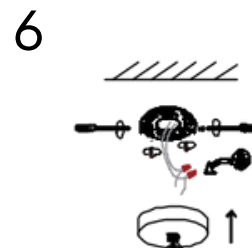

5
The electric wires in the home connect to the light fixtures

8x lampshade

8x bulb

Install bulbs and lampshades

