



step1

General purpose hanging board installation diagram Fix the hanging plate on the wall



step2

Connect the lamp body wire to the power cord.



step3

Hang the rings on the hanger



1. Drill holes in the installation plate according to the hole position of the hanging plate
2. Hammer the expansion screw plug into the hole for later use

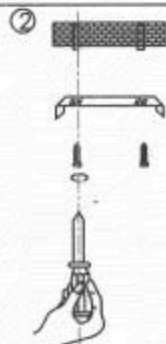

Secure the hanging plate with self-tapping screws

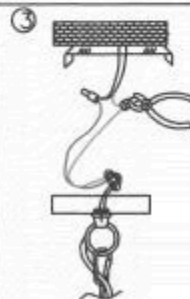

Connect the positive and negative poles of the lamp wire and the room wire separately, connect the wires and clamp them with wiring caps

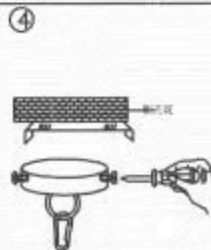

Align the side holes of the suction top plate with the holes of the hanging plate, connect the hanging plate to the suction top plate with a Phillips screwdriver, and then lock them with a screwdriver



Attention!!

1. Check the package for completeness before installation. Whether the lamps are in good condition
2. Cut off the main wire before installation. Wiring is in progress. 3. Install the lamp body first. Then install the power supply.
3. Installation and maintenance must be done by professional technicians

Maintenance precautions

When maintaining the lamps, be sure to cut off the power supply to avoid electric shock

1: In order to use this product efficiently and safely, please regularly check and clear the oil of the lamps and lanterns. During the inspection, ensure the firmness of the connecting parts of the lamp body, the pre-arranged parts and load-bearing hooks and chains in the ceiling to prevent aging without being noticed.

2: In the cleaning process, if the light source is replaced, it is recommended to choose good quality and long life of famous brand products, to avoid the trouble of increasing the replacement of light source.
3: when cleaning the lamp, do not rotate the lamp body, in order to avoid the loosening of the external screw teeth of the lamp body, resulting in unsafe accidents.

4: when wiping beads, it is suggested that warm with a soft cloth with water diluted detergent, gently lower on the surface of the crystal beads according to mop (when wiping can't hold down, to pass from break strings) if the water bead all down to clear, want to note down the bead lamp body balance, should match about disassembly, otherwise it will lead to the lamp body tilt, lead to light box deformation in vitro.

5: wipe the lamp body bracket, with a soft cloth not running water, especially alcohol, gasoline and so on to wipe, (wipe if found that the non-bead connection buckle rust or crystal bead defect, should be replaced in time)