

Model: TQ-42

Model: TQ-28

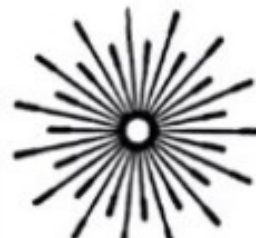

Model: TQ-30



Note: The installation steps for the TQ-30 and TQ-28 are the same as those for the TQ-42, as shown in the pictures.

Step 1: Open the packaging and take out the ceiling light, then firmly attach each lamp arm to the back with the gauge as shown in the illustration.

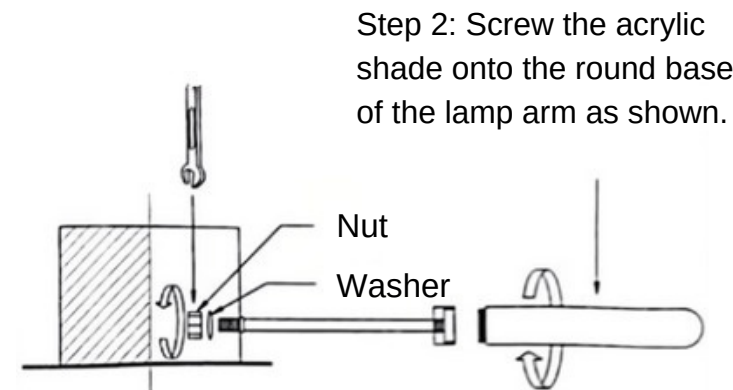

Step 2: Screw the acrylic shade onto the round base of the lamp arm as shown.

Step 3: Attach the junction board as shown to the ceiling of the room with the screws from the kit.

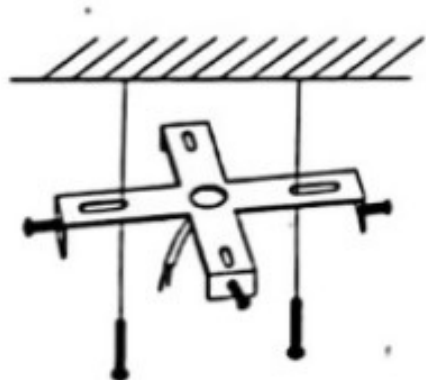

Step 4: Then connect the input of the light driver as shown to the household power cable.

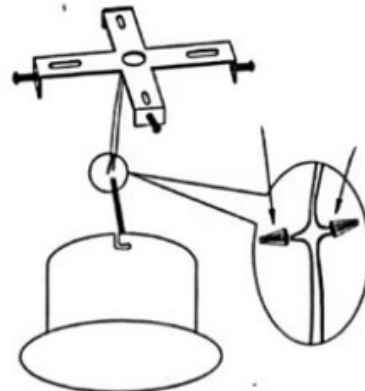

Step 5: Lift the lamp base upward and rotate it at a slight angle so that the screws go into the corners of the holes in the base, as shown in the picture. Finally, secure the lamp base to the junction board with the screws.

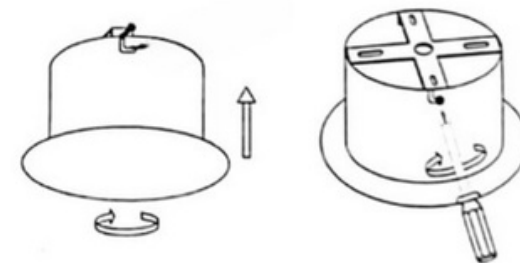

Note: If you have any questions about installing the luminaire, feel free to contact us. You can also watch the installation instruction video on the product homepage.