

## Installation steps

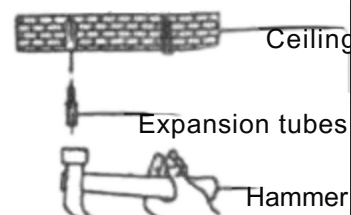

1. First take the cross-hanging plate and mark the holes for the self-tapping screws on the ceiling and punch them. Then use a hammer to hammer the expansion tube into the ceiling

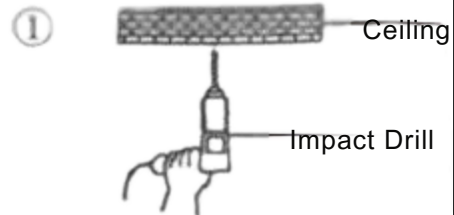
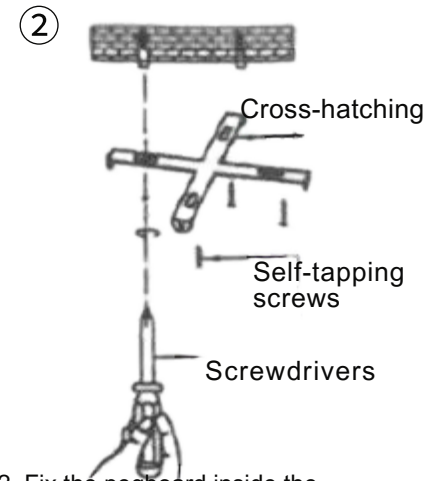

2. Fix the pegboard inside the expansion tube of the ceiling with self-tapping screws and lock the cross pegboard tightly with a screwdriver.

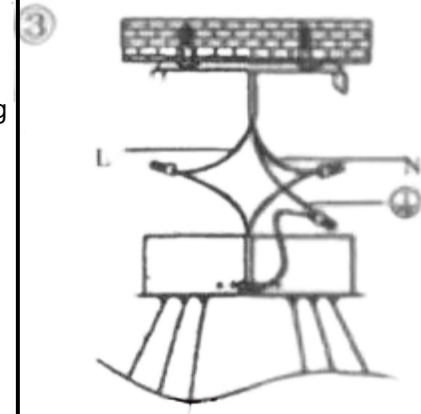

3. Connect the wires in the ceiling and the lamps with zero wire and zero wire, fire wire and fire wire, earth wire and earth wire, respectively, and then tighten the wires with wiring caps and tie them with ties

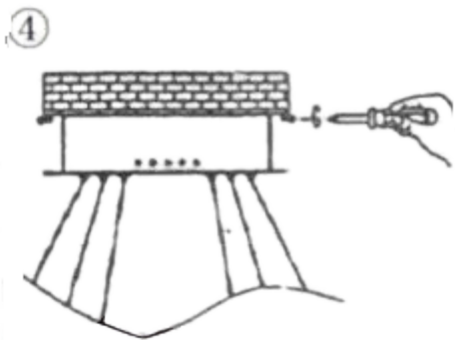

4. Place the ceiling plate against the ceiling, align the side holes of the suction prep plate with the holes of the cross peg plate, screw the round head screws into the screw holes of the peg plate with a screwdriver and lock them in place

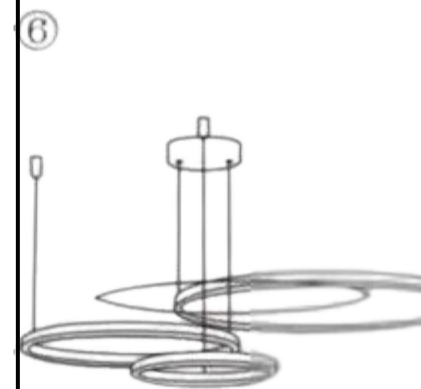
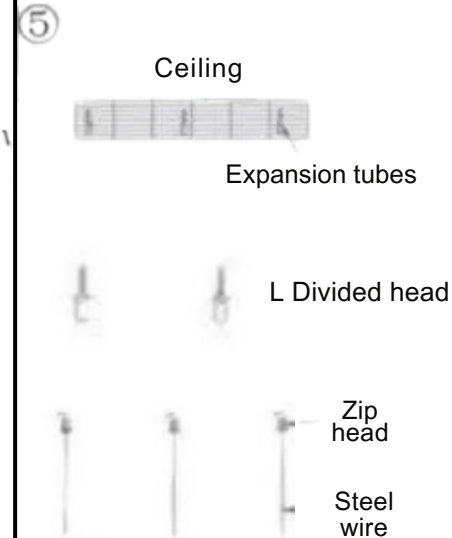

5. Installation is complete and the light can be illuminated.

## Notes:

1. Before installation, please check that the parts are complete and that the luminaire is in good condition.
2. Disconnect the power supply before installation and carry out wiring.
3. When installing the light bulb, use a light bulb with a wattage lower than that shown as the light head label.
4. Installation and maintenance must be carried out by a professional technician.