

1: According to the hanging plate hole, Punching installation holes

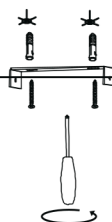

2: Drive in the expansion pipe, Screw fixed hanging plate

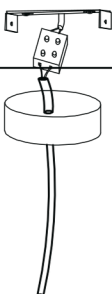

3: Wiring, brown fire Line L, blue zero line N

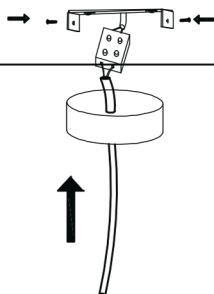

4: Screw fixed ceiling plate

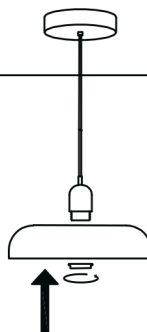

5: Install the lampshade

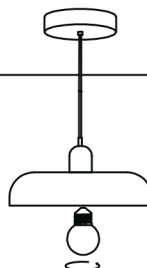

6: Installing bulb

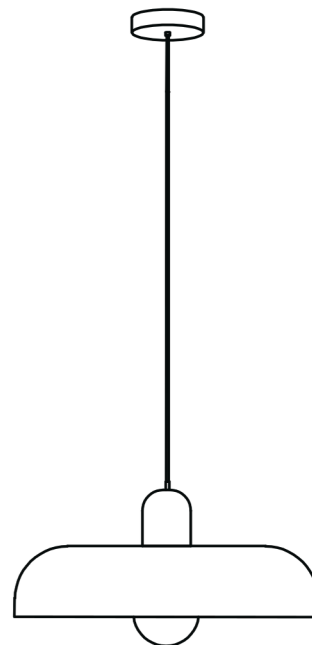

Attention!!

- 1: Check the package for completeness before installation. Whether the lamps are in good condition.
- 2: Cut off the main wire before installation. Wiring is in progress.
- 3: Install the lamp body first. Then install the power supply. Installation and maintenance must be done by professional technicians

Maintenance precautions when maintaining the lamps, be sure to cut off the power supply to avoid electrocution

- 1: In order to use this product efficiently and safely, Please check the life of the lamps regularly. During the inspection, ensure the firmness of the connecting parts of the lamp body, the pre-arranged part and load-bearing hooks and chains in the ceiling to prevent aging without being noticed.
- 2: In the cleaning process, If the light source is replaced, it is recommended to choose good quality and long life of famous brand products, to avoid the trouble of increasing the replacement of light source.
- 3: When cleaning the lamp, do not rotate the lamp body, in order to avoid the loosening of the external screw threads of the lamp body, resulting in unsafe accidents.
- 4: When wiping the lamps, it is recommended to dilute the detergent with water and use SOLT tape to warm the surface of the lamp to keep it warm. If the lampshade needs to be removed for cleaning, it's important to pay attention to the balance of the body of the luminaire, otherwise it will cause the lamp to tilt, which will lead to deformation of the luminaire.
- 5: Wipe the lamp body bracket, use a soft rag do not use running water, (especially alcohol, gasoline and soapy water) to wipe, if found in the lamps and lanterns without bead rust or crystal bead defects should be replaced in time.